

# Nantwich Walled Garden Society Newsletter

## Issue No. 2, Summer 2015

Welcome to Issue No. 2 of the *Nantwich Walled Garden Society Newsletter*. We hope that you found Issue No. 1 (Winter 2014-15) to be of interest, and would welcome your comments and feedback on Issue No. 2, together with any suggestions for topics to be included in future issues. If you missed Issue No. 1, it's on the Society's web site here: <http://tinyurl.com/ntfoxx6>.

### English Heritage Re-assessment of Garden Walls

A partial assessment of the walls surrounding the Nantwich Walled Garden (NWG) was undertaken by English Heritage (EH) in 2006, which led to their being categorised as Grade 2 listed. A full re-assessment was undertaken in late 2014, and in early 2015 EH confirmed the Grade 2 listing (except the missing section of the west wall) and amended and amplified the designation in their listing record due to the garden's historical and architectural interest, early date of construction and the materials used. The NWG Society were particularly pleased that the report reaffirms EH's earlier statement on the historical national significance of the NWG. This, along with its inclusion in the Nantwich conservation area, ensures that the current and any future owner of the site must retain and ensure future maintenance of the walls. Unfortunately this does not at present directly assist with the NWG Society's objective to restore the garden, as the site is still owned by a property developer.



The full EH report (list number 1115809) is here: <http://list.historicengland.org.uk/resultsingle.aspx?uid=1115809>.

### Nantwich Walled Garden as a Visitor Attraction

Nantwich is a town with many attractive features which make it a lovely place to live and visit. The Town Council organise a range of events for the local community and tourists, with knock-on benefits to local businesses. If the NWG could be restored as a garden, this would only enhance our town further – the garden would be a unique attraction as there is nothing similar in Nantwich open to the public.

Although there are many delightful walled gardens around the country, there are very few which are in such close proximity to a town centre. To visit most you need a car, whereas the location of the NWG close to Welsh Row means that it could easily be reached from the railway and bus stations, on foot by local residents, and even from the canal (for visitors arriving by boat). If the NWG can be acquired, the NWG Society would work to restore the walls and garden, and develop it as a tourist attraction. This would be in addition to its objective to involve local schools, colleges, community groups and members of the public.

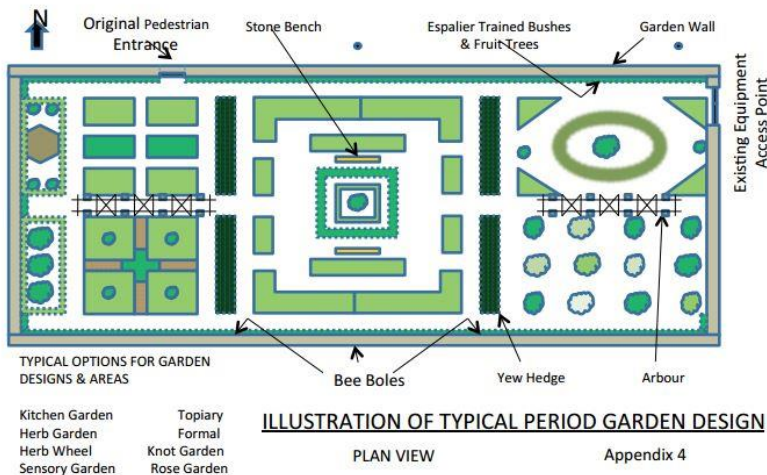

If the garden and walls can be restored, our plan would be for it to be a tribute to John Gerard so that his contributions to botany and herbs, and his connections with Nantwich, can be commemorated. This would doubtless attract national and international visitors with interests in herbs, botany and Elizabethan history, as well as gardeners and visitors here for other reasons.

## History within the Garden Walls



The Nantwich Walled Garden has history embedded in its walls, an example being the three bee boles which are located within the south wall. Bee boles (a

Scots word for a recess in a wall), were used to house and protect bee skeps (a predecessor to bee hives, made of straw and requiring protection from the weather). As well as attracting the bees into the garden to pollenate the plants and providing honey for consumption by the occupants of Townsend House, the beeswax produced could also have been used for candles, and the honey for making mead and for use as an antiseptic.

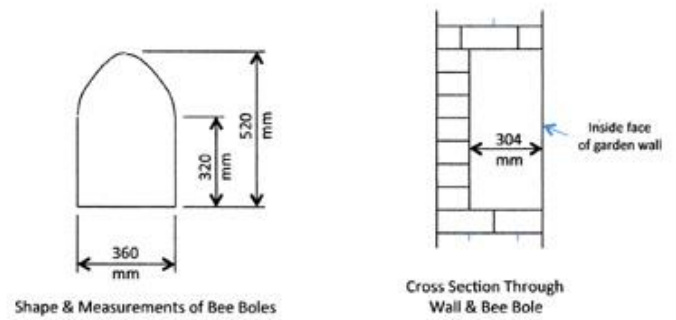

## John Gerard and Shakespeare

In the last Newsletter we talked about the link between John Gerard, the herbalist and author of *The Herball or Generall Historie of Plantes* who was born in Nantwich in 1545, and his sharing of William Shakespeare's interest in folklore. The possible connection between Gerard and Shakespeare was featured in the May 2015 edition of *Country Life* <http://www.countrylife.co.uk/features/world-exclusive-the-true-face-of-shakespeare-revealed-for-the-first-time-video-72243>. Further information can be found on the NWGS website <http://www.nantwichwalledgarden.org.uk/Shakespeare.htm>.

## Meet the Nantwich Walled Garden Society

The NWGS will have a stand at the 2015 Societies Spectacular, to be held in Nantwich Town Square on Saturday 18<sup>th</sup> July 2015. Please come along to say hello! There will also be the opportunity to find out more about our campaign and to join the Society should you wish to do so.

**Would you like to get involved?** If so, please send an email to our Chairman, follow us on Twitter or Facebook, and visit our web site. We welcome input from all members of our community to help us secure the future of this important historic site in our town.

### Further Information

Join the Nantwich Walled Garden Society: email: [chairman@nantwichwalledgarden.org.uk](mailto:chairman@nantwichwalledgarden.org.uk) or complete the form here [http://www.nantwichwalledgarden.org.uk/images/Membership\\_form\\_2015.pdf](http://www.nantwichwalledgarden.org.uk/images/Membership_form_2015.pdf). Annual subscription: £10 (family membership).

Visit: Nantwich Museum, Pillory Street, Nantwich.

Visit our website: <http://www.nantwichwalledgarden.org.uk/index.htm>



Listen to a podcast: <https://soundcloud.com/redshift-audiocasts/audioinform-nantwich-walled>



Follow us on Twitter: <http://twitter.com/NantwichWGS>



Follow us on Facebook: <http://www.facebook.com/NantwichWalledGardenSociety>